

# Hammonds



Flat G 147 Hoe Street, London, E17 3AL

£950 PCM

- Great Location
- Recently Refurbished
- Laminate Flooring
- Close to Transport Links

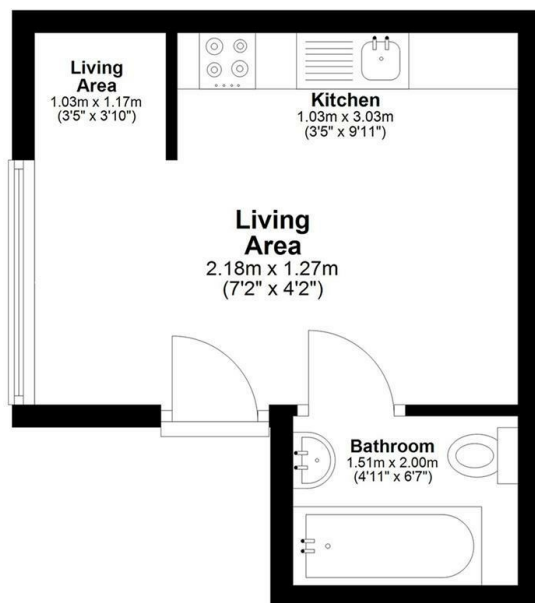

Hammonds

**Evolve**  
www.evolve-uk.co.uk

This floor plan is for illustrative purposes only.  
Floor areas (including total floor area) openings are approximate.

**TOTAL FLOOR AREA**

Sq. meters	10.9
Sq. feet	116.8

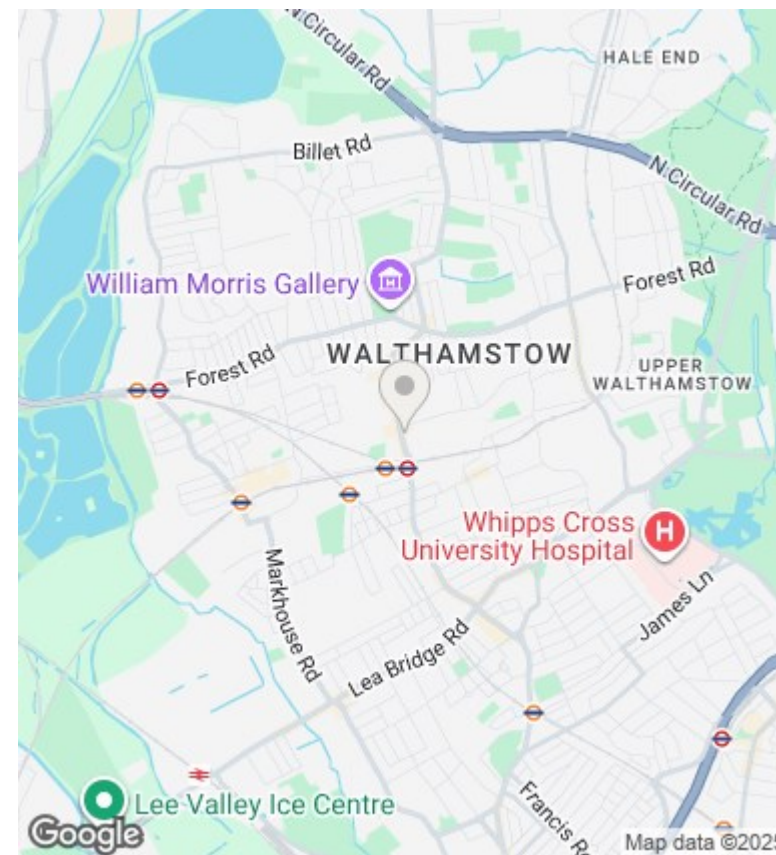

## Directions

## Viewings

Viewings by arrangement only. Call 02089802226 to make an appointment.

## Council Tax Band

## EPC Rating:

Energy Efficiency Rating		
	Current	Potential
Very energy efficient - lower running costs		
(92 plus) <b>A</b>		
(81-91) <b>B</b>		
(69-80) <b>C</b>		
(55-68) <b>D</b>		
(39-54) <b>E</b>		
(21-38) <b>F</b>		
(1-20) <b>G</b>		
Not energy efficient - higher running costs		
<b>England &amp; Wales</b>	EU Directive 2002/91/EC	